

**ROAD TRAFFIC REGULATION ACT 1984**  
**WORCESTERSHIRE COUNTY COUNCIL**  
**(DISTRICT OF WYCHAVON – NON-URBAN AREA)**  
**(PERMITTED PARKING AREA AND SPECIAL PARKING AREA)**  
**(WAITING RESTRICTIONS AND STREET PARKING PLACES)**  
**CONSOLIDATION ORDER 2004 (VARIATION) ORDER 2025**

**[PROHIBITION OF WAITING/LIMITED WAITING ON C2118 HIMBLETON]**

Worcestershire County Council in exercise of their powers under Section 1(1), 2 (1) to (3), 3 (1), 4(2) and 124 and Part IV of Schedule 9 of the Road Traffic Regulation Act 1984 (which said Act is hereinafter referred to as "the Act of 1984") and of all other powers them enabling in that behalf, and after consultation with the Chief Officer of Police in accordance with Part III of Schedule 9 to the said Act of 1984, hereby make the following Order:-

1. The Worcestershire County Council (District of Wychavon – Non-Urban Area) (Permitted Parking Area and Special Parking Area) (Waiting Restrictions and Street Parking Places) Consolidation Order 2004 is hereby varied by the attachment thereto of the plan attached to this Order (which has the effect of imposing on the lengths and sides of roads identified in the plan attached to this Order Prohibition of Waiting and Limited Waiting 8am - 4pm, 1 hour, no return within 1 hour & Prohibition of Waiting 4pm – 8am in accordance with the provisions of the Consolidation Order).
2. The Order shall come into operation on 16 January 2025 and may be cited as Worcestershire County Council (District of Wychavon – Non-Urban area) (Permitted Parking Area and Special Parking Area) (Waiting Restrictions and Street Parking Places) Consolidation Order 2004 (Variation) Order 2025 [Prohibition of Waiting/Limited Waiting on C2118 Himbleton]

Dated 9 January 2025

The Common Seal of  
Worcestershire County Council was  
hereunto affixed in the presence of: )

*Clare Taylor*  
CLARE TAYLOR  
PRINCIPAL SOLICITOR



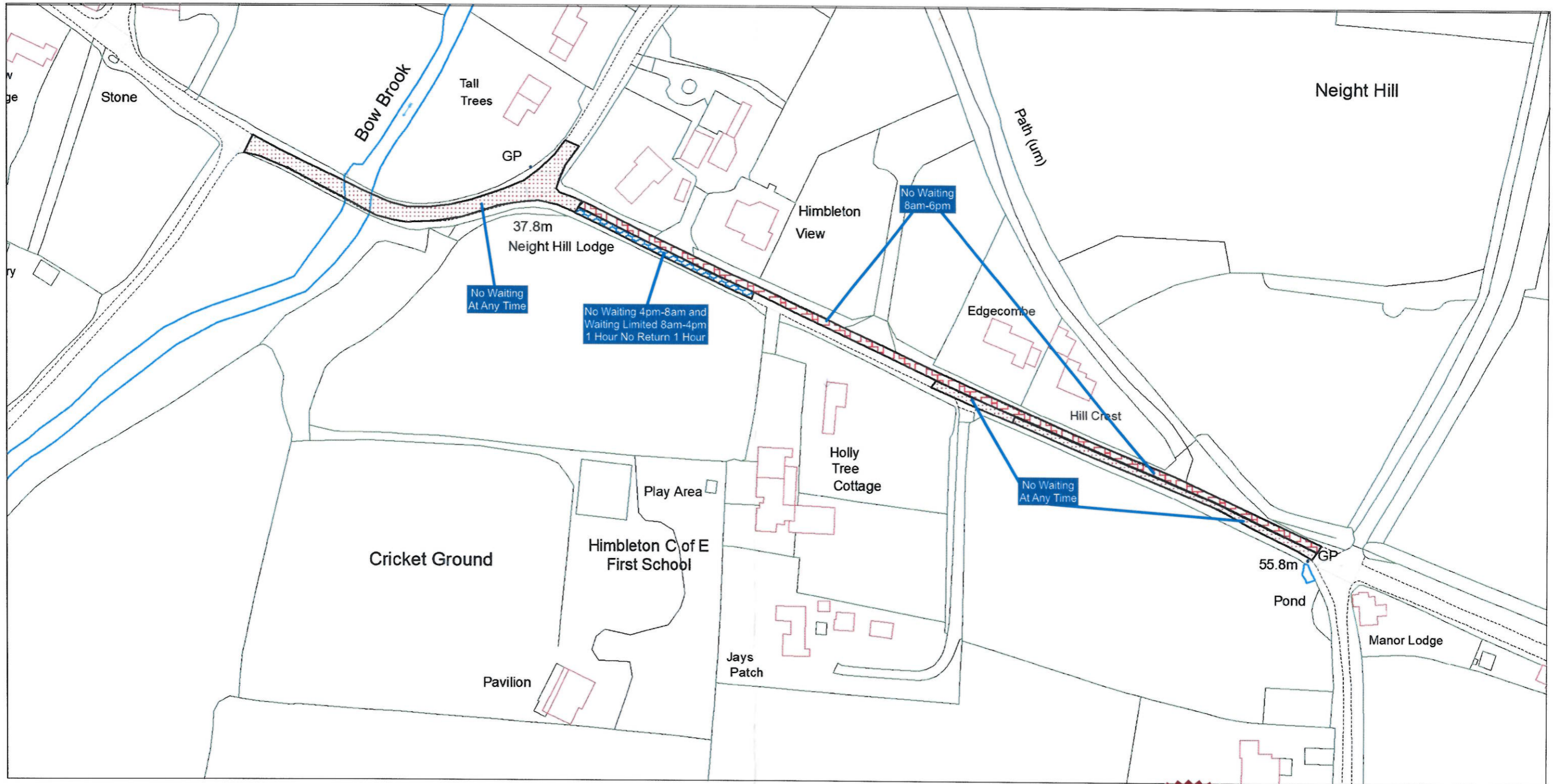

WORCESTERSHIRE COUNTY COUNCIL

(DISTRICT OF WYCHAVON - NON-URBAN AREAS)

(PERMITTED PARKING AREA AND SPECIAL PARKING AREA)

(WAITING RESTRICTIONS AND STREET PARKING PLACES) CONSOLIDATION ORDER 2004



*Clare Taylor*  
CLARE TAYLOR  
PRINCIPAL SOLICITOR



Wychavon District Council  
Civic Centre  
Queen Elizabeth Drive  
Perschore  
Worcestershire  
WR10 1PT

SCALE - 1:1250

This map is reproduced from Ordnance Survey material with the permission of Ordnance Survey on behalf of the Controller of Her Majesty's Stationary Office  
© Crown copyright. Unauthorised reproduction infringes Crown copyright and may lead to prosecution or civil proceedings.  
Worcestershire County Council, LA 09073L. For reference purposes only. No further copies may be made.