

Qty: 1 Ref: 13-9 Schedule 13 - Temporary Sign	
Qty: 2 Ref: 2702 Start of temporary diversion route	
Qty: 2 Ref: 2702 End of temporary diversion route	
Qty: 2 Ref: 2702 Start of temporary diversion route	
Qty: 2 Ref: 2703 Direction of temporary diversion route from junction ahead	
Qty: 2 Ref: 2703 Direction of temporary diversion route from junction ahead	
Qty: 6 Ref: 2703 Direction of temporary diversion route from junction ahead	
Qty: 1 Ref: 573 Direction to hazard left	
Qty: 1 Ref: 573 Direction to hazard right	
Qty: 2 Ref: 7001 Road works ahead	
Qty: 2 Ref: 7010-FP-13-9 Nature of temporary hazard ahead - Road Closed	
Qty: 4 Ref: 7010-FP-13-9 Nature of temporary hazard ahead - Road Ahead Closed	

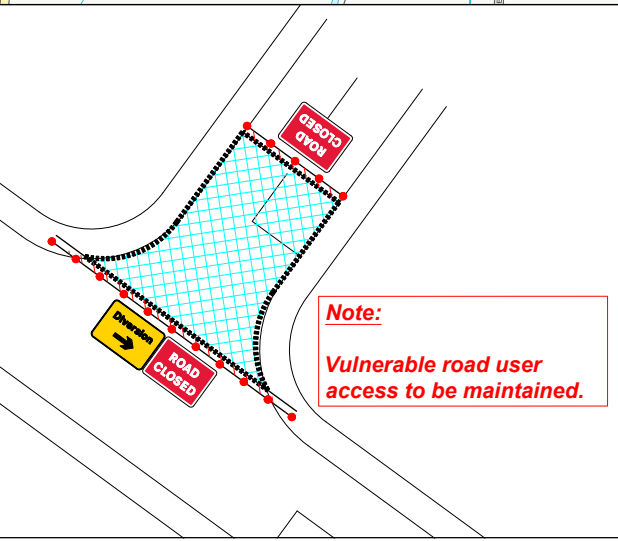

**Go Traffic Management**

This drawing has been produced for a specific client & project identified below and is not intended for use by any other person or for any other purpose. © Go Traffic Management

**Risks**

- Design completed from information provided + google maps desktop risk assessment
- Cone lamps must be used on all road with a speed limit of 40mph or more.

**Notes**

- All signs as per Chapter 8. Distances between cones to be 9m maximum unless otherwise noted.
- Distances between signs NOT to scale for purpose of clarity.
- All sign placement subject to available safe working space.
- The purpose of the Traffic Management Plan is for it to be used only as a guide and all traffic management equipment should be put out according to the 'Safety at Street Works and Road Works - Code of Practice', i.e. Red Book & the 'Traffic Signs Manual Chapter 8', i.e. Yellow Book.
- Signs must be placed in accordance with TSM and the scheme RAMS pack.
- Site conditions may have changed since the design of the drawing any changes which subsequently affect the design need to be reported by the Traffic Management Operative & any changes implemented must comply with Chapter 8.

**Key**

	Sign position and aspect of view		Working Space
	Cone		Diversion Route 1

CLOSED - USRN: 45405071  
DIVERSION VIA - USRN: 45405071, USRN: 45404751, USRN: 45401416, and Vice Versa.

MINIMUM 5M SAFETY ZONE OF 0.5M MUST BE ADHERED TO  
Traffic Management must comply with The Safety at Street Works and Road Works Code of Practice

**ROAD SPEED**

**CROSS SECTION**

DO NOT SCALE FROM THIS DRAWING	Road Closure	
A	14/04/26	AS DRAWN
REV.	DATE	DESCRIPTION

**GTM**  
**Go Traffic Management**

Head Office: Go Traffic Management,  
Chaddock Lane, Worsley, Manchester, M28 1XW  
Tel: 0161 351 5370  
www.gtm.co.uk

**TRAFFIC MANAGEMENT PLAN**

Client: **SEVERN TRENT WATER**

Drawing Number: 1753134.0001

Drawing Title: Dunhampstead, Droitwich, WR9 7JX

Design:	Technical Officer:	REV:
Name: D.Smith	M.Gardiner	
Signature:		A
Date: 14/04/26	14/04/26	